

SURGICAL LIGHTS / PREVENTIVE MAINTENANCE

Wearing parts replacement cycle

Leaflet rev. 02 - associated with FSCA ref. MSA-808092

Page: 1 of 17

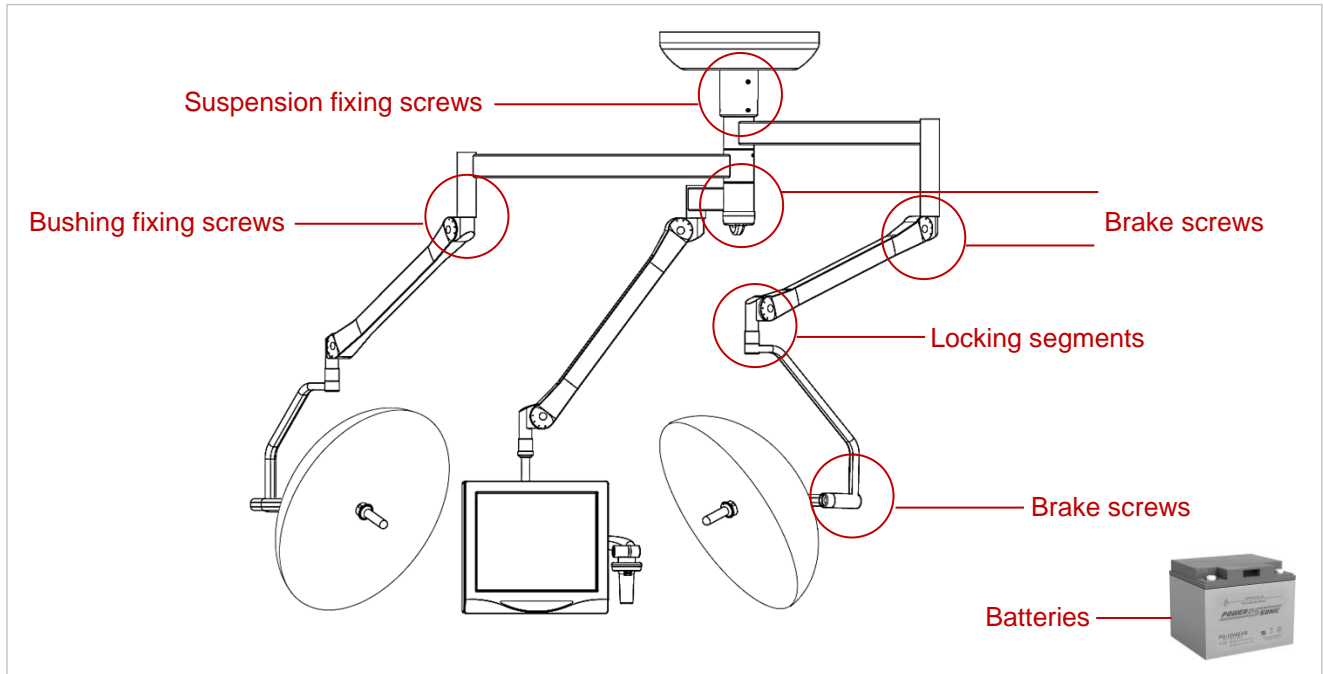

SUBJECT

GETINGE reminds to carry out preventive maintenance and wearing parts replacement to ensure the device safety.

The **brake screws** must be replaced every year to avoid any drift of the devices during the surgical procedures.

The **batteries** must be replaced every 3 years.

The **suspension fixing screws**, the **bushing fixing screws** and the **locking segments** must be replaced every 6 or 10 years.



1. If screws appear loosened, replace them, do not retighten these screws, it can lead to a breakage.
2. Please tighten the replacement fixing screws (new) to the recommended tightening torques.

Maquet SAS

Parc de Limère, Avenue de la Pomme de Pin, Ardon
CS 10008, 45074 Orléans cedex 2
France

1- SUSPENSION FIXING SCREWS

A- SB / TUB Ø 65

Fixing screws for **SB** suspensions on **TUB Ø 65**

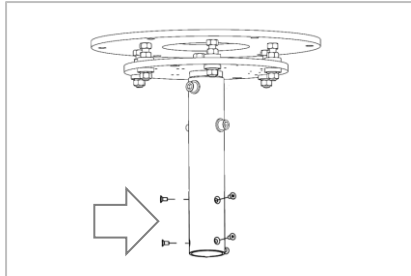

Replacement
Cycle
Every 6 Years

Tightening torque
16 Nm

B- PRC & PRX / TUBE ECL Ø 100

Fixing screws for **PRISMATIC** & **PRISMALIX** suspensions on **TUBE ECL Ø 100**

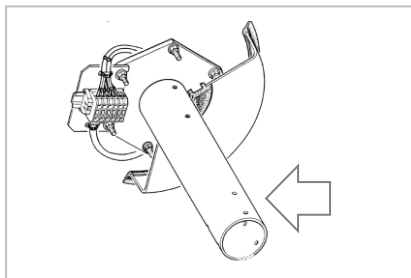

Replacement
Cycle
Every 6 Years

Tightening torque
16 Nm

C- SA / TUB Ø 130

Fixing screws for **SA** suspensions on **TUB Ø 130**

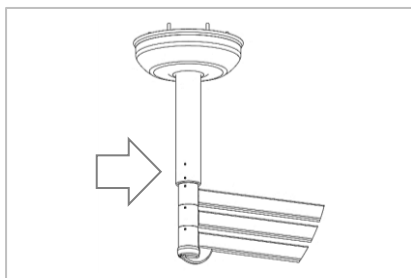

Replacement
Cycle
Every 6 Years

Tightening torque
16 Nm

Maquet SAS

Parc de Limère, Avenue de la Pomme de Pin, Ardon
CS 10008, 45074 Orléans cedex 2
France

D- SA / TUB SAT

Fixing screws for **SA** suspension on **TUB SAT** axle 1

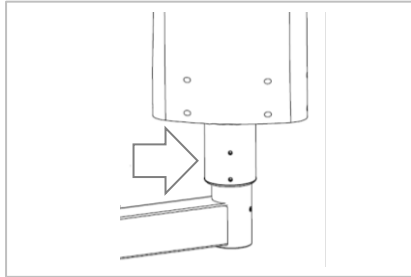

Replacement
Cycle
Every 6 Years

Tightening torque
16 Nm

E- SAT / TUB SAT

Fixing screws for **SA** suspension on **TUB SAT** axle 2-3

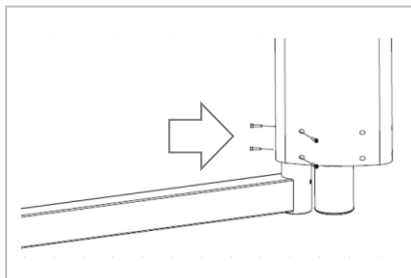

Replacement
Cycle
Every 6 Years

Tightening torque
16 Nm

F- SAX / TUBX

Fixing screws for **SAX** suspensions on **TUBX**

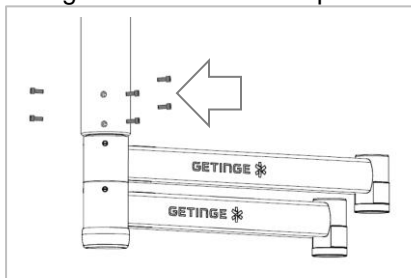

Replacement
Cycle
Every 10
Years

Tightening torque
50 Nm

Maquet SAS

Parc de Limère, Avenue de la Pomme de Pin, Ardon
CS 10008, 45074 Orléans cedex 2
France

G- SAX / TUBX SATX

Fixing screws for **SAX** suspensions on **TUBX SATX** axle 1

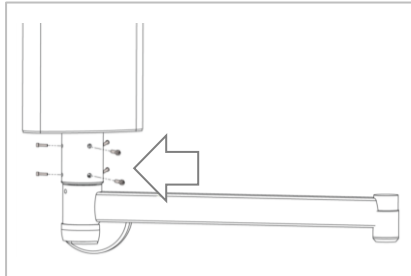

Replacement
Cycle
Every 10
Years

Tightening torque
50 Nm

H- SATX / TUBX SATX

Fixing screws for **SATX** suspension on **TUBX SATX** axle 2-3

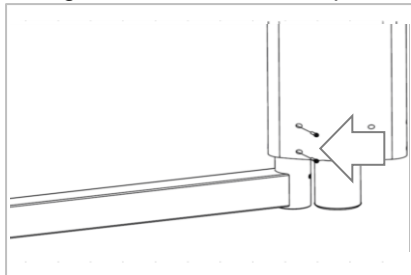

Replacement
Cycle
Every 10
Years

Tightening torque
16 Nm

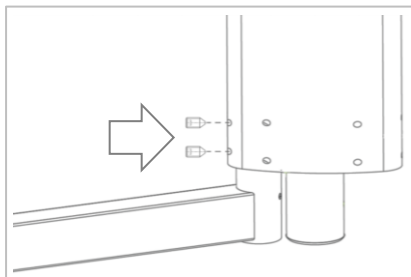

Replacement
Cycle
Every 10
Years

Tightening torque
50 Nm

*The kit **ARD369508555** includes 4 pre-coated screws CHC ISO4762 M6x25 & 2 screws HC ISO4027 M12x20. The 2 screws M12x20 don't need threadlocker.

Maquet SAS

Parc de Limère, Avenue de la Pomme de Pin, Ardon
CS 10008, 45074 Orléans cedex 2
France

2- ADAPTER FIXING SCREWS

A- SB / TUB Ø 130 or SB / TUB SAT AXLE 1 with ADAPTER 120 TO 65

Fixing screws for adapter on SB suspension axle

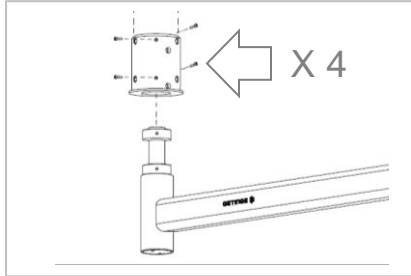

Replacement
Cycle
Every 6 Years

Tightening torque
16 Nm

Fixing screws for adapter on TUB 130 or TUB SAT axle 1

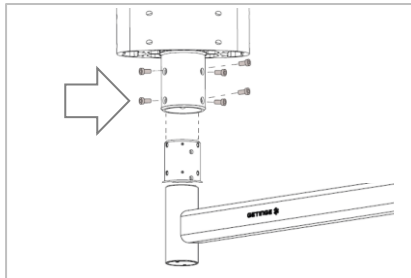

Replacement
Cycle
Every 6 Years

Tightening torque
16 Nm

B- SA / TUBE HLX 2000 with ADAPTER FOR TUBE HANAULUX2000

Fixing screws for HLX2000 adapter on SA suspension axle

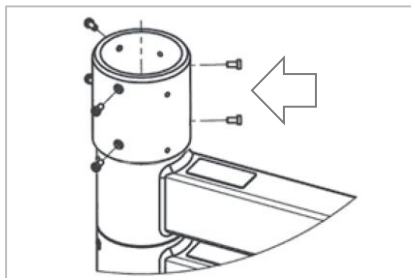

Replacement
Cycle
Every 6 Years

Tightening torque
16 Nm

Fixing screws for HLX2000 adapter on tube HANAULUX2000

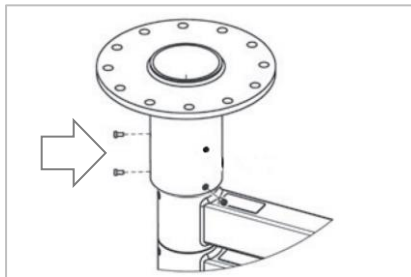

Replacement
Cycle
Every 6 Years

Tightening torque
16 Nm

Maquet SAS

Parc de Limère, Avenue de la Pomme de Pin, Ardon
CS 10008, 45074 Orléans cedex 2
France

C- SA / TUBE HANAU CITY with ADAPTER FOR TUBE HANAU CITY

Fixing screws for adapter on SA suspension axle

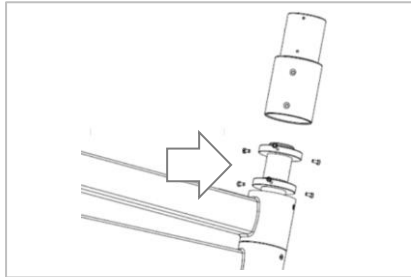

Replacement
Cycle
Every 6 Years

Tightening torque
16 Nm

Fixing screws for adapter on tube HANAU CITY

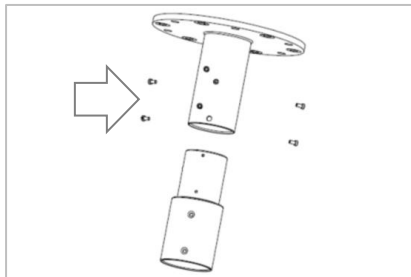

Replacement
Cycle
Every 6 Years

Tightening torque
16 Nm

*The kit **ARD397808555** includes 6 precoated screws CHC M6x20 & 6 screws FHC M6x16.

D- SB / TUBX or SB / TUBX SATX AXLE 1 with ADAPTER 120 TO 65

Fixing screws for adapter on SB suspension axle

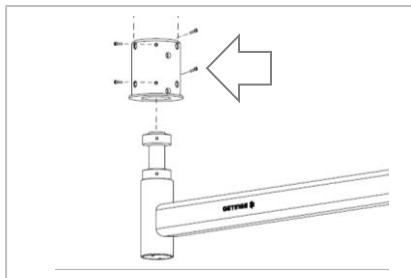

Replacement
Cycle
Every 6 Years

Tightening torque
16 Nm

Fixing screws with adapter on TUBX or TUBX SATX axle 1

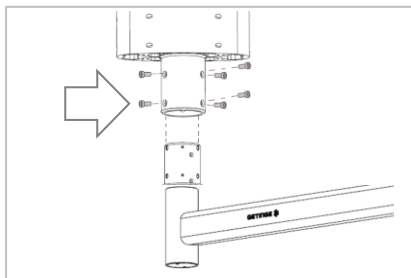

Replacement
Cycle
Every 6 Years

Tightening torque
50 Nm

Maquet SAS

Parc de Limère, Avenue de la Pomme de Pin, Ardon
CS 10008, 45074 Orléans cedex 2
France

E- SAX / TUBE HLX 2000 with ADAPTER FOR TUBE HANAULUX2000

Fixing screws for HLX2000 adapter on SAX suspension axle

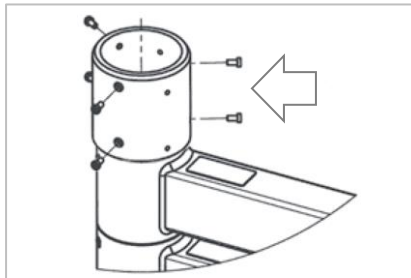

Replacement Cycle
Every 6 Years

Tightening torque
50 Nm

Fixing screws for HLX2000 adapter on tube HANAULUX2000

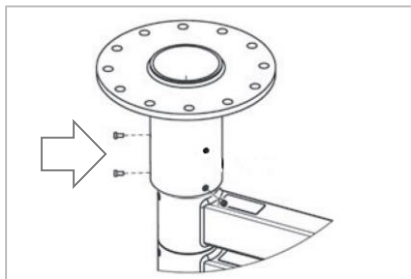

Replacement Cycle
Every 6 Years

Tightening torque
16 Nm

F- SAX / TUBE HANAU CITY with ADAPTER FOR TUBE HANAU CITY

Fixing screws for adapter on SAX suspension axle

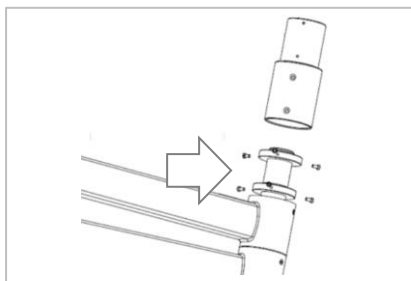

Replacement Cycle
Every 6 Years

Tightening torque
50 Nm

Fixing screws for adapter on tube HANAU CITY

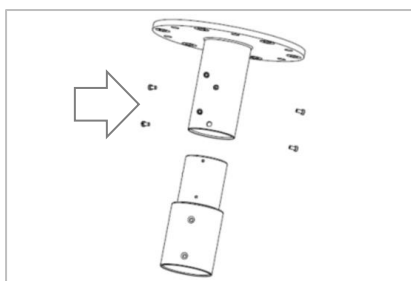

Replacement Cycle
Every 6 Years

Tightening torque
16 Nm

Maquet SAS

Parc de Limère, Avenue de la Pomme de Pin, Ardon
CS 10008, 45074 Orléans cedex 2
France

3- BUSHING FIXING SCREWS

A- SA-SAT-SAX-SATX SUSPENSION BUSHING FIXING SCREWS

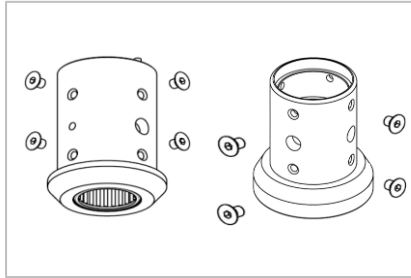

Replacement
Cycle
Every 6 Years

Tightening torque
6 Nm

Warning: Lower torque due to
different material

B- SAT MEDIA SUSPENSION BUSHING FIXING SCREWS

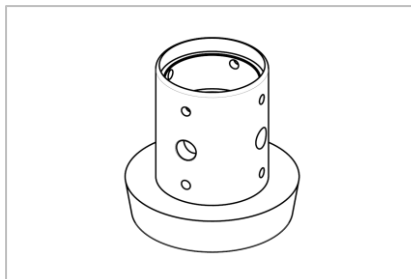

Replacement
Cycle
Every 6 Years

Tightening torque
16 Nm

C- SB (SN < 600 000) SUSPENSION BUSHING FIXING SCREWS

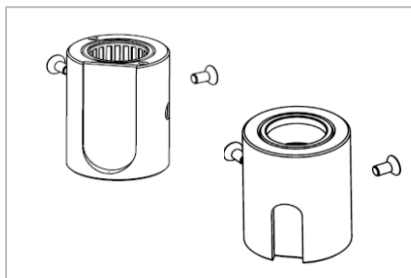

Replacement
Cycle
Every 6 Years

Tightening torque
16 Nm

4- BRAKE SCREWS

A- SA & SAX SUSPENSION AXLE BRAKE SCREWS L 28

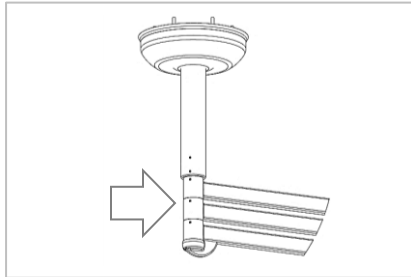

Replacement
Cycle
Every Year

B- SAT & SATX SUSPENSION AXLE BRAKE SCREWS L 24

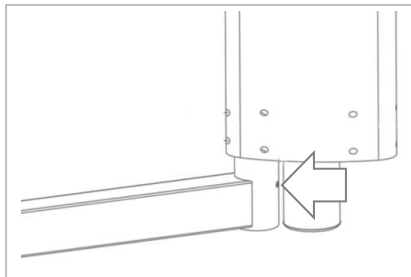

Replacement
Cycle
Every Year

C- SA-SAT & SAX-SATX SUSPENSION BUSHING BRAKE SCREW FOR AC2000 & VALIA Ø 32 SPRING ARM L 17

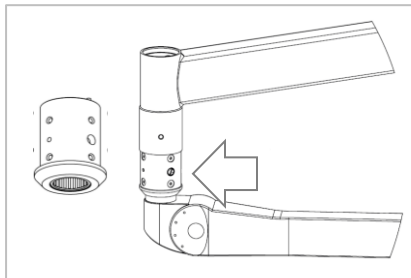

Replacement
Cycle
Every Year

D- SA-SAT & SAX-SATX SUSPENSION BUSHING BRAKE SCREW FOR ONDASPACE & VALIA Ø 50 SPRING ARM L 13

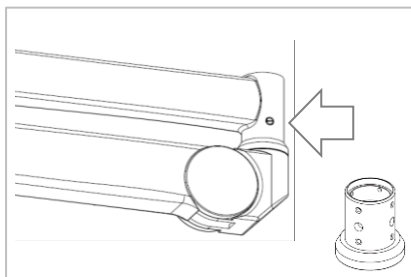

Replacement
Cycle
Every Year

Maquet SAS

Parc de Limère, Avenue de la Pomme de Pin, Ardon
CS 10008, 45074 Orléans cedex 2
France

E- BRAKE SCREW FOR “AC2000” HORIZONTAL FITTING SPRING ARM L 11

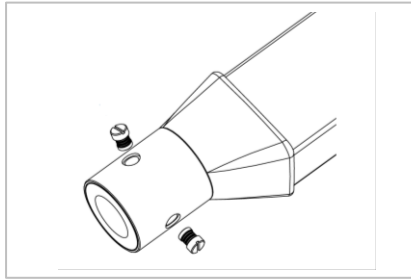

Replacement
Cycle
Every Year

F- BRAKE SCREW FOR “ONDASPACE” HORIZONTAL FITTING SPRING ARM L 18

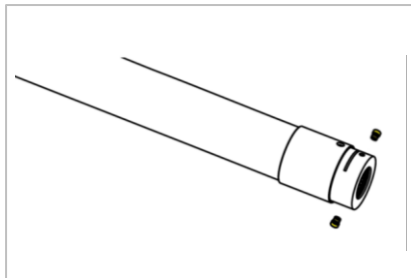

Replacement
Cycle
Every Year

G- BRAKE SCREW FOR “VALIA LCH” HORIZONTAL FITTING SPRING ARM L 11.8

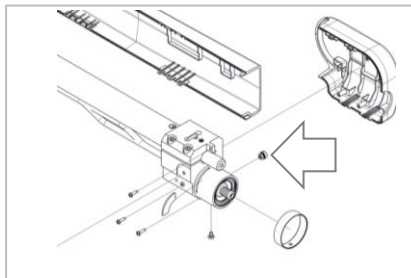

Replacement
Cycle
Every Year

H- RECOMMENDED GREASE FOR “VALIA LCH” HORIZONTAL FITTING SPRING ARM BRAKE SCREWS

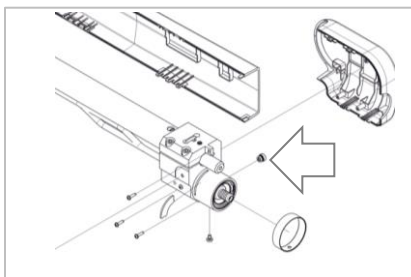

Replacement
Cycle
Every Year

*When installing the brake screw, it is recommended to apply MICROGLEIT grease on the friction surface of the brake screw in order to improve the braking effect. The tubes are also delivered with the spring arms.

Maquet SAS

Parc de Limère, Avenue de la Pomme de Pin, Ardon
CS 10008, 45074 Orléans cedex 2
France

I- BRAKE SCREW FOR “OASYS” HORIZONTAL FITTING SPRING ARM (VOLISTA ACCESS & LUCEA)

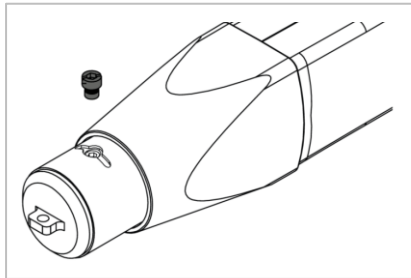

Replacement
Cycle
Every Year

J- BRAKE SCREW FOR “POWERLED HLED” DOUBLE FORK AXLE L 20

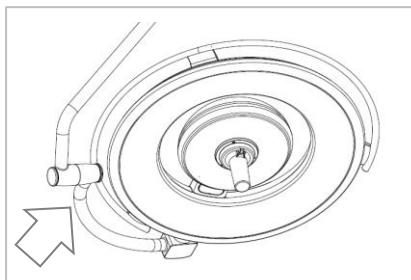

Replacement
Cycle
Every Year

K- BRAKE SCREW ON “POWERLED HLED” LIGHT HEAD AXLE L 15

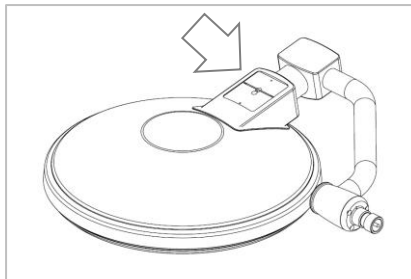

Replacement
Cycle
Every Year

L- BRAKE SCREW ON “VOLISTA” LIGHT HEAD AXLE L 18

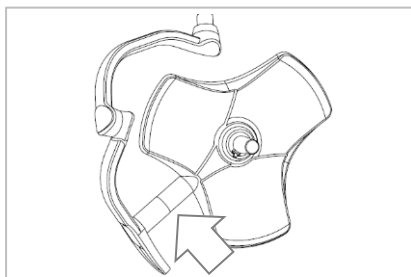

Replacement
Cycle
Every Year

Maquet SAS

Parc de Limère, Avenue de la Pomme de Pin, Ardon
CS 10008, 45074 Orléans cedex 2
France

M- BRAKE SCREW ON “VOLISTA” DOUBLE FORK LIGHT HEAD L 20

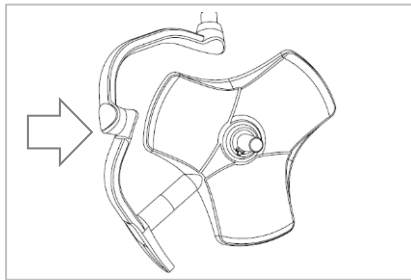

Replacement
Cycle
Every Year

N- BRAKE SCREW ON “POWERLED II” LIGHT HEAD AXLE & DOUBLE FORK LIGHT HEAD L 20

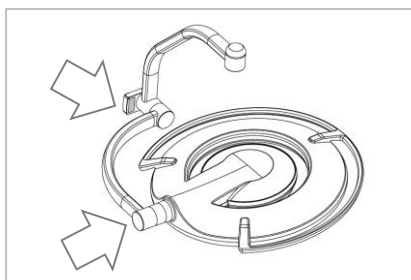

Replacement
Cycle
Every Year

Maquet SAS

Parc de Limère, Avenue de la Pomme de Pin, Ardon
CS 10008, 45074 Orléans cedex 2
France

5- LOCKING SEGMENTS

A- LOCKING SEGMENT FOR “ONDASPACE” HORIZONTAL FITTING SPRING ARM (POWERLED I, POWERLED II, VOLISTA)

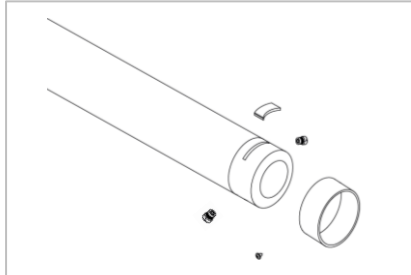

Replacement
Cycle
Every 6 Years

B- LOCKING SEGMENT FOR “ONDASPACE” HORIZONTAL FITTING SPRING ARM (G8)

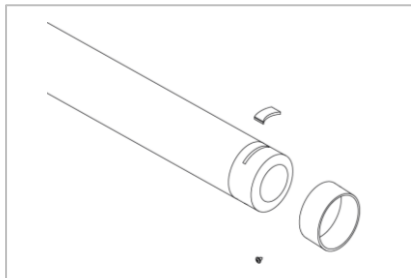

Replacement
Cycle
Every 6 Years

C- LOCKING SEGMENT FOR “ONDASPACE” VERTICAL FITTING SPRING ARM

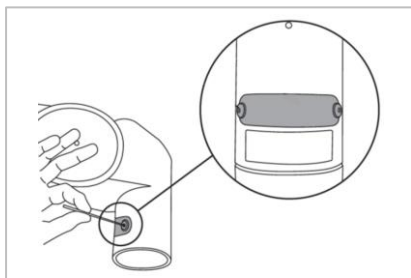

Replacement
Cycle
Every 6 Years

D- LOCKING SEGMENT FOR “AC 2000” HORIZONTAL FITTING SPRING ARM

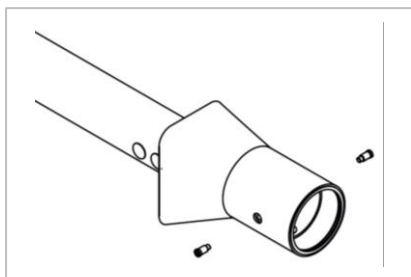

Replacement
Cycle
Every 6 Years

Maquet SAS

Parc de Limère, Avenue de la Pomme de Pin, Ardon
CS 10008, 45074 Orléans cedex 2
France

E- LOCKING SEGMENT FOR “AC 2000” VERTICAL FITTING SPRING ARM

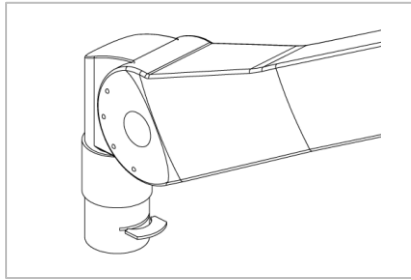

Replacement
Cycle
Every 6 Years

F- LOCKING SEGMENT FOR “VALIA MD+” VERTICAL FITTING SPRING ARM

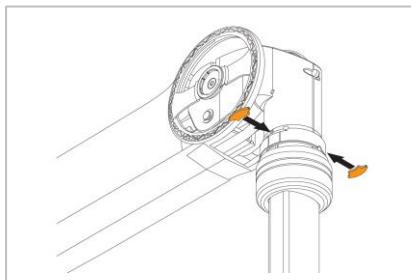

Replacement
Cycle
Every 10
Years

G- LOCKING SEGMENT FOR “VALIA L/MD” VERTICAL FITTING SPRING ARM

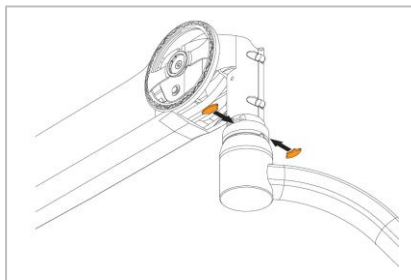

Replacement
Cycle
Every 10
Years

H- LOCKING SEGMENT FOR “VALIA LCH” HORIZONTAL FITTING SPRING ARM

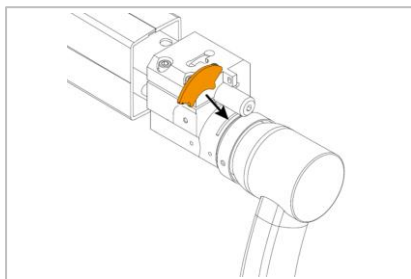

Replacement
Cycle
Every 10
Years

Maquet SAS

Parc de Limère, Avenue de la Pomme de Pin, Ardon
CS 10008, 45074 Orléans cedex 2
France

I- LOCKING SEGMENT FOR "OASYS" VERTICAL FITTING SPRING ARM

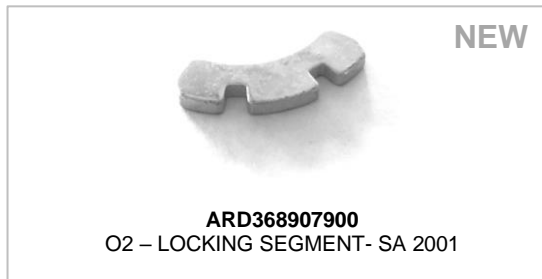
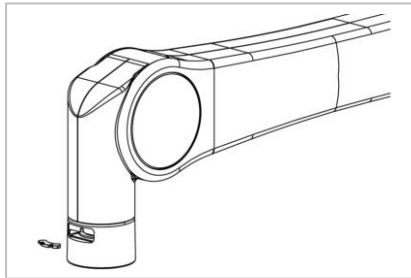

Replacement
Cycle
Every 10
Years

J- LOCKING SEGMENT FOR "OASYS" HORIZONTAL FITTING SPRING ARM

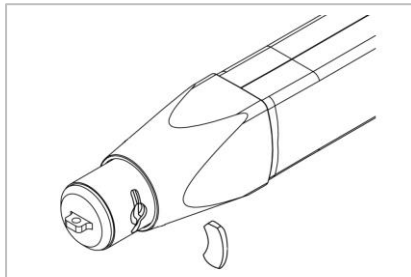

Replacement
Cycle
Every 10
Years

Maquet SAS

Parc de Limère, Avenue de la Pomme de Pin, Ardon
CS 10008, 45074 Orléans cedex 2
France

6- BATTERIES

A- BATTERY BACK UP : POWERLED I - WPS580



Replacement
Cycle
Every 3 Years

B- MOBILE : ROLITE - BLUE 80 - LUCEA 100

N.B. : Order 2 pieces for 1 device.



Replacement
Cycle
Every 3 Years

C- MOBILE : LUCEA 50



Replacement
Cycle
Every 3 Years

D- BATTERY BACK UP : POWERLED II - VOLISTA

N.B. : Depending of the back up option (1h or 3h) order 1 pair or 2 pairs.



Replacement
Cycle
Every 3 Years

Maquet SAS

Parc de Limère, Avenue de la Pomme de Pin, Ardon
CS 10008, 45074 Orléans cedex 2
France

Should you have any questions, do not hesitate to contact our Technical Support :
internationalsupport.surgicallights@getinge.com

Service Product OR Lights
Surgical Workflows / International Technical Service

Maquet SAS

Parc de Limère, Avenue de la Pomme de Pin, Ardon
CS 10008, 45074 Orléans cedex 2
France